

# ITX-i2203

## Intel® Celeron® Processor N3160 Embedded Mini-ITX motherboard

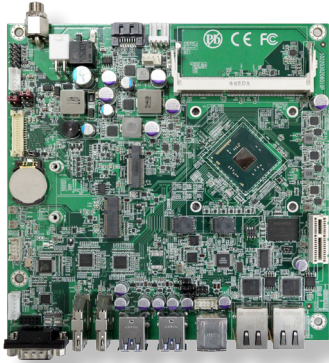

### Features

- Low profile design
- Soldered onboard Intel® Celeron® Processor N3160
- Dual Gigabit Ethernet ports
- 2 x HDMI ports, dual Channel 24-bit LVDS
- Dual independent displays supported
- Anti-Crash Technology for automatical system BIOS recovering
- Support Intel® M.2 SSD

### System

Processor	Soldered onboard Intel® Celeron® Processor N3160 1.6GHz
Memory	1 x DDR3L SO-DIMM socket, supporting up to 8GB 1333/1600MT/s SDRAM
BIOS	AMI BIOS
Watchdog Timer	1~255 levels reset

### I/O

Super I/O	Fintek F81801
Serial Port	1 x Serial Port, RS-232/422/485 selectable
Keyboard & Mouse	6-pin wafer connector for PS/2 keyboard/ mouse via Y-cable
USB 2.0	4 x USB 2.0 ports
USB 3.0/2.0	4 x USB 3.0/2.0 ports
Expansion	1 x PCIe x1 slot
	1 x NGFF M.2 E-key socket for Wireless
	1 x micro SIM socket (OEM request)

Storage	1 x Serial ATA port with 600MB/s HDD transfer rate
	1 x NGFF M.2 B-key socket for SSD
	Soldered onboard up to 32GB eMMC (OEM request)

Ethernet Chipset	2 x Intel® i210AT PCIe GbE controllers
Audio Interface	Realtek® ALC269 5.1 Channel HD Audio CODEC, Mic-in/ Line-in/ Line-out with Amplifier

### Display

Graphic Chipset	Integrated Intel® HD Graphics
Graphic Interface	2 x HDMI ports
	1 x Dual channels 24-bit LVDS via PTN3460BS

### OS Support

Windows 8.1 64-bit	
--------------------	--

### Mechanical & Environmental

Power Input	DC 24V
Power Consumption	0.56A@+24V (max.)
	0.36A@+24V (min.)
Operating Temp.	-20 ~ 70°C (-4 ~ 158°F)
Operating Humidity	10 ~ 95% @ 70°C (non-condensing)
Dimension (L x W)	170 x 170 mm (6.7" x 6.7")

### Dimensions

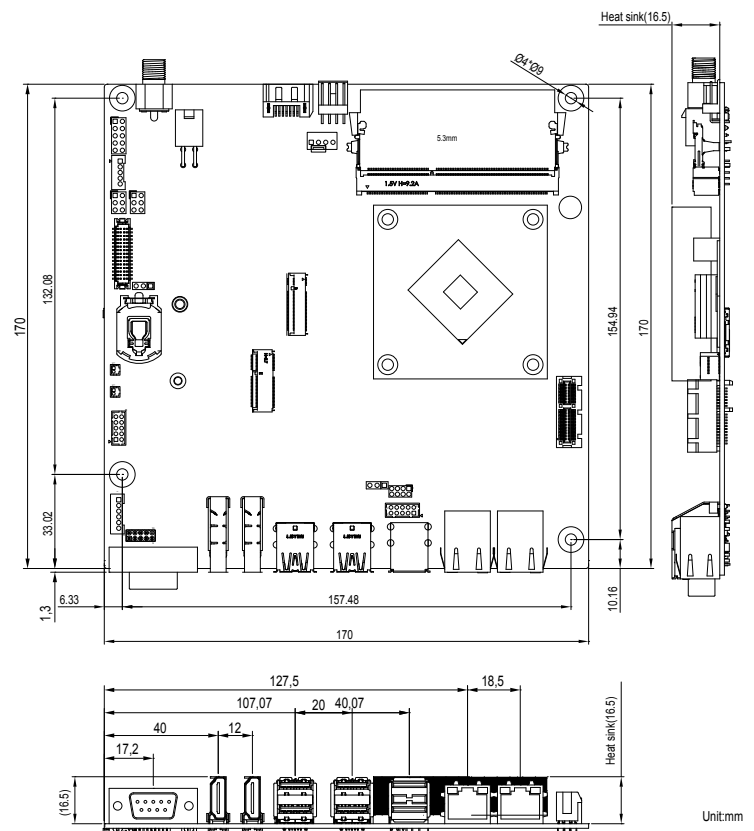

Unit:mm

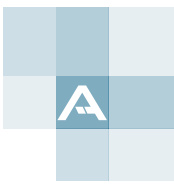

## Board Block Diagram

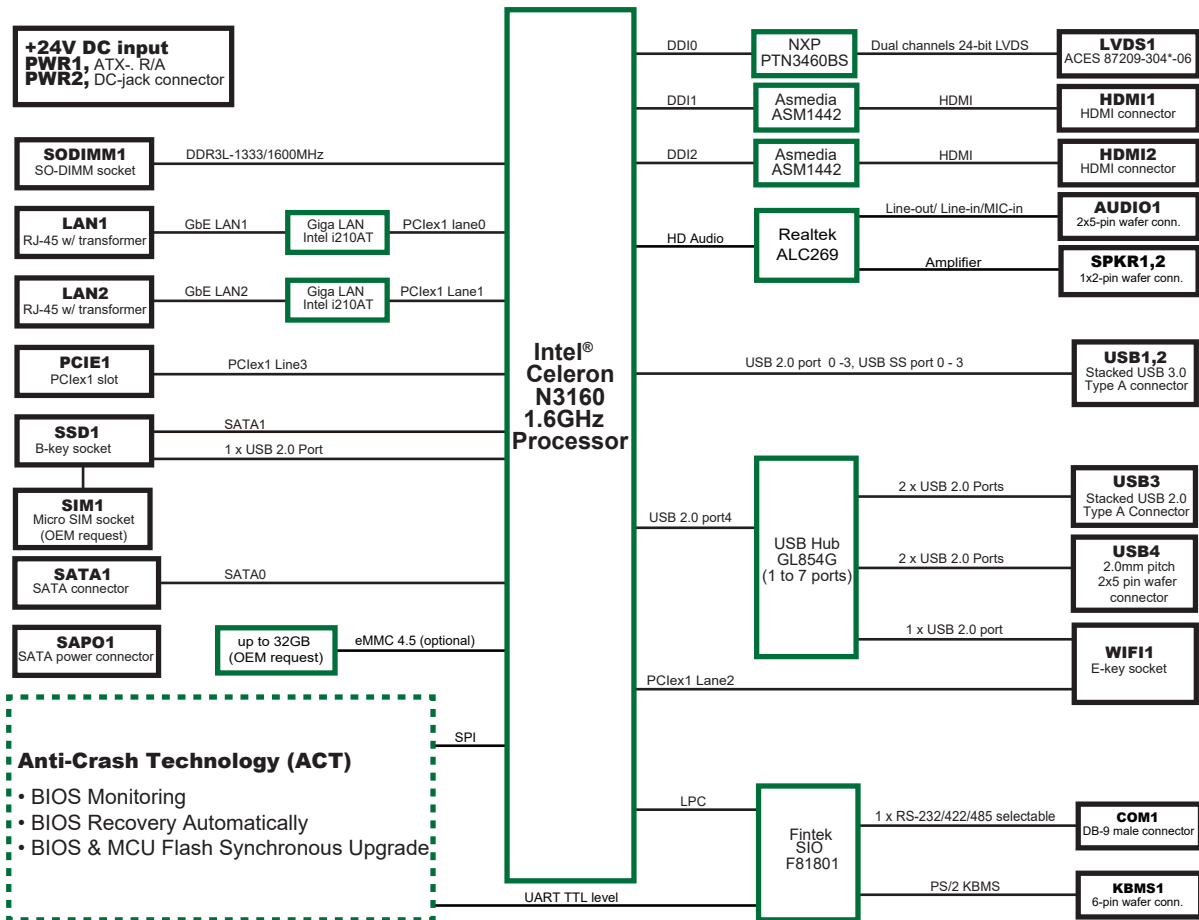

### ACT Block Diagram

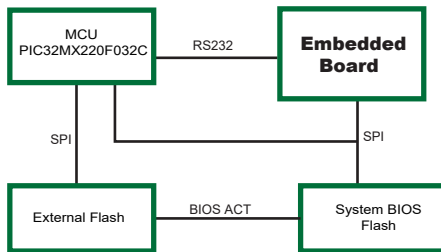

## Ordering Information

ITX-i2203-N3160

Intel® Celeron® Processor N3160 Mini-ITX motherboard w/ ACT

## Optional Accessories

CBK-04-2203-00

Cable Kit  
 1 x SATA and SATA power cable  
 1 x Keyboard/ mouse cable  
 1 x Audio cable  
 1 x USB cable